

A73 gPV 1000VDC Fuse 10x38mm



FEATURES:

- 1000 VDC, 10x38mm PV fuse link
- Rated Current: 1~30A
- Rated Breaking Capacity: 30 kA
- Time Constant: 1-3ms
- Special design with silver plated caps for high-power PV applications
- Reference Standard: UL 2579/UL 248
- Approvals: UL 2579 Listed (File: E490190)

ELECTRICAL SPECIFICATIONS

Part Number	Rated Current	Breaking Capacity	I ² t (A ² s)		Dissipation (W)		Certifications
			Pre-Arc	Total at 1000V	80% In	100% In	
A731100700	1A	30kA@ 1000V DC	0.15	0.4	0.8	1.5	●
A731200700	2A		1.3	3.4	0.7	1.1	●
A731300700	3A		4	12	0.8	1.3	●
A731400700	4A		10	28	1.1	1.4	●
A731500700	5A		19	50	1.1	1.4	●
A731600700	6A		32	93	1.2	1.8	●
A731800700	8A		85	205	1.2	2.2	●
A732100700	10A		30	70	1.3	2.3	●
A732120700	12A		98	150	1.5	2.8	●
A732150700	15A		149	230	1.8	3.0	●
A732200700	20A		229	330	2.4	3.6	●
A732250700	25A		411	500	2.6	4.1	●
A732300700	30A		1200	2500	4.3	5.7	●

Note: (1) DC Cold Resistance are measured at <10% of rated current in ambient temperature of 25°C

(2) Typical pre-arcing I²t measured at 10 I_n current

DIMENSIONS (mm)

A73xxx700

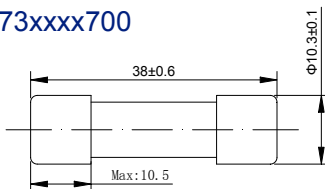

A73xxx701

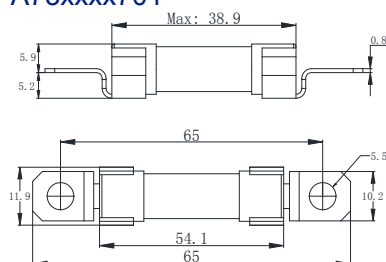

A73xxx702

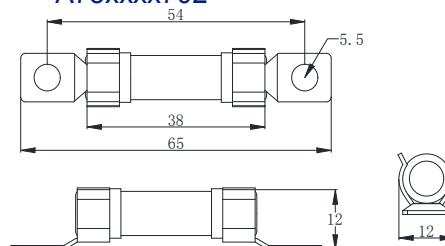

APPLICATIONS:

- PV combiner/ junction boxes
- Inverters
- Battery Charge Controllers

Time Current Curve (reference)

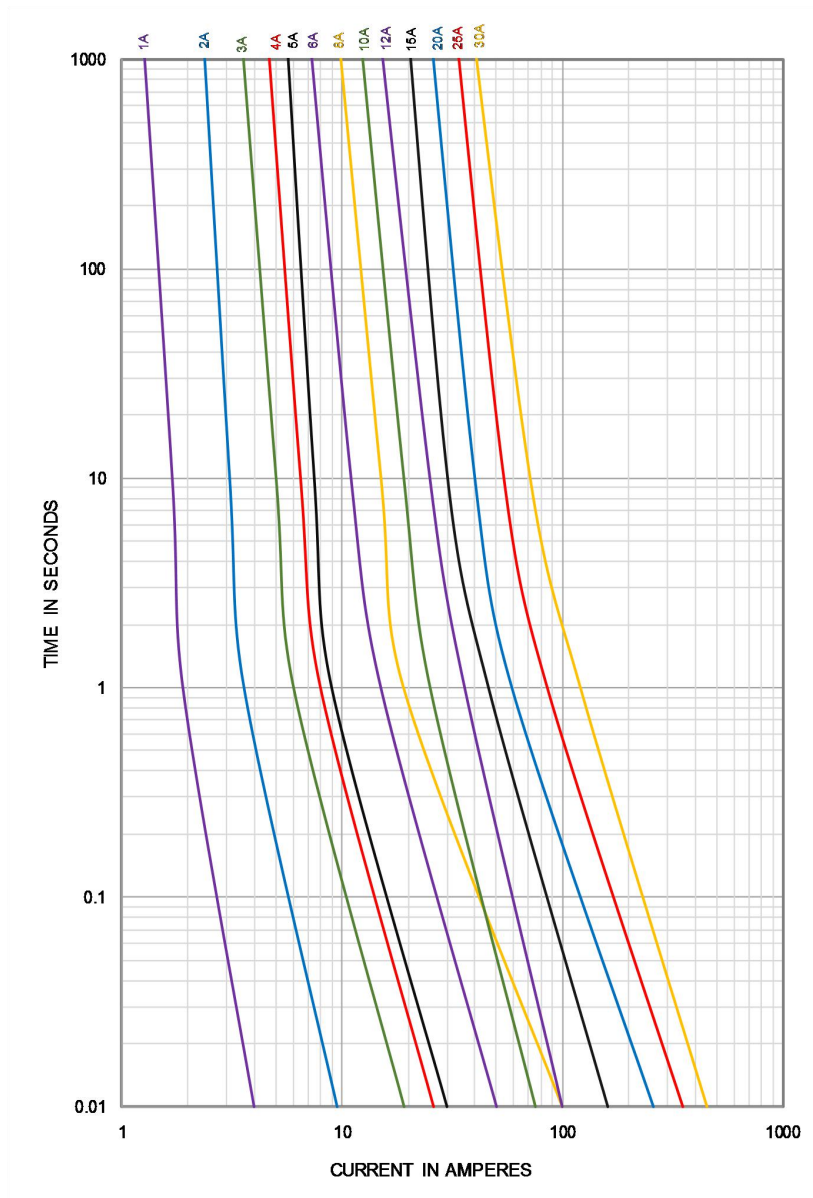

MATCHING FUSE HOLDERS/ ACCESSORIES:

- BH100, BH101, BH100-00 holders for DIN rail mounting
- 10x38mm fuse clips BC800.



BC800



BH101 (with indicator) / BH100